

# SUPPLEMENTARY REGULATIONS



## *Oregon Trail Rally*

**May 31<sup>st</sup> – June 2<sup>nd</sup>, 2019**

And Rich Olmstead Regional Rally

***Portland International Raceway  
Goldendale, Washington  
Dufur, Oregon***

Round 4 of the



***Championship Series Presented by AMSOIL***

Organized and Promoted by:



Oregon Rally Group  
P.O. Box 3511  
Tualatin, OR 97062

## Welcome to the 2019 Oregon Trail Rally!

We are very happy to have you competing at Oregon Trail and hope to make it the best rally that you will attend this year. We are truly grateful that you have chosen our event and know that you have options when choosing where to exercise your passion!

Oregon Rally Group is a non-profit, and Oregon Trail is organized by over 20 volunteer committee members who have been working diligently on this event since the 2018 rally finished. The event is also supported by over 300 volunteers the week of the rally!

Please do not hesitate to contact me with any questions that you may have about the rally.

I look forward to seeing you in May!



Doug Heredos  
Event Chair  
503-709-0937  
doug.heredos@gmail.com

Section 1: Event Timetable	4
Section 2: Rally Headquarters	5
Section 3: Airports	5
Section 4: Organization	5
Section 5: Description	6
Section 6: Entry and Entry Fees	7
Section 7: Scrutineering	8
Section 8: Event Sponsor Advertising	8
Section 9: Service	9
Section 10: Course Notes/Pace Notes	10
Section 11: Optional Recce	10
Section 12: Press Stage and Charity Shakedown	11
Section 13: Traffic Infringements and Other Oregon Laws	12
Section 14: Marshals' Identification	12
Section 15: Reseeds	12
Section 16: Chicanes and barricades	12
Section 17: Amendments to the Regulations - Supplements	13
Section 18: Exceptions from American Rally Association Rules	13
Section 19: Transiting After a Stage Stoppage	13
Section 20: Weather contingency	14
Section 21: Mileage Markers	14
Section 22: Damage to PIR Facility and Service Area Cleanup	14
Section 23: Provisional Scores	14
Section 24: Awards	14
Section 25: Prize Giving	15
Section 26: Maps	16

The Oregon Trail Rally is organized and promoted by the Oregon Rally Group  
[www.oregonrally.com](http://www.oregonrally.com) and sanctioned by the American Rally Association  
[www.americanrallyassociation.com](http://www.americanrallyassociation.com).

## Section 1: Event Timetable

### Wednesday, May 29

1600 - 2000	Recce Registration	Portland Location TBA
1900 - 2000	Note writing class	Portland Location TBA

### Thursday, May 30

0700 - 0800	Recce Registration	Rally HQ - Fairfield Inn, 2014 W 7 <sup>th</sup> The Dalles, OR 97058
0730 - 1800	Open Recce	Klickitat & Wasco Counties

### Friday, May 31

0930	Service area open for move-in	Portland International Raceway
1000 - 1500	Scrutineering <do this before registration>	Portland International Raceway
1030 - 1530	Registration	2 <sup>nd</sup> Floor Infield Tower at PIR
1030 - 1300	Shakedown and Press Stage	Portland International Raceway
1200 - 1530	Media Registration	2 <sup>nd</sup> Floor Infield Tower at PIR
1400 - 1500	<b>Novice Drivers' Class</b>	3 <sup>rd</sup> Floor Infield Tower at PIR
1500	Optional Timecard Explanation	3 <sup>rd</sup> Floor Infield Tower at PIR
1530	Stewards Meeting	3 <sup>rd</sup> Floor Infield Tower at PIR
1600	Mandatory Briefing for Media	2 <sup>nd</sup> Floor Infield Tower at PIR
1700	Parade Lap	Portland International Raceway
1800	Parc Exposé	North Paddock Area of PIR
1815	Mandatory Drivers' Meeting	North Paddock Area of PIR
1815	Seeded Draw	During driver's meeting
1900 - 2100	Spectator Stages	Portland International Raceway
2100	First Car Finishes Day 1	Portland International Raceway

### Saturday, June 1

0800	Service area open for move-in	Goldendale High School
0900 - 1000	Parc Exposé	Eagle's Aerie, 2006 W 7th St, The Dalles, OR 97058
0930	Mandatory Drivers' Meeting	Eagle's Aerie, The Dalles
1000	First Car Starts Day 2	Eagle's Aerie, The Dalles
~1800	First Car Finishes Day 2	Pete's Pizza, Goldendale, WA
~1800	Begin mid-rally Party	Pete's Pizza, Goldendale, WA
~1900	Cars released from mid-rally party	

### Sunday, June 2

0800	Service area open for move-in	Dufur City Park
0900 - 1000	Parc Exposé	Dufur Main Street
0930	Mandatory Drivers' Meeting	Dufur Main Street
1000	First Car Starts Day 3	Dufur Main Street
~1700	First Car Finishes Day 3	Dufur Threshing Bee
~1800	Post-Rally Festivities	Dufur Threshing Bee
~1900	Provisional Scores Posted	Dufur Threshing Bee

## Section 2: Rally Headquarters

The rally headquarters is the Fairfield Inn & Suites at 2014 West 7th Street, The Dalles, Oregon 97058. The hotel is located just off I-84 at exit 83.

Registration will take place Friday, May 31, between 10:30 AM and 3:30 PM on the 2<sup>nd</sup> floor of the infield tower at Portland International Raceway, 1940 N. Victory Blvd, Portland, Oregon 97217. See the [map of PIR in section 26](#) for exact location and PIR move-in route.

## Section 3: Airports

The nearest passenger airport is Portland International Airport (PDX), located at 7000 NE Airport Way, Portland OR 97218. It is located in Northeast Portland along the Columbia River. Please see <http://www.flypdx.com> for airline information.

## Section 4: Organization

### Organizing Committee:

Chair / Sponsors	Doug Heredos	503-709-0937	doug.heredos@gmail.com
Clerk of the Course	Rebecca Ruston	503-679-9414	rebecca@oregonrally.com
Chief of Emergency Serv.	Beth Sharer	503-435-8369	bmsharer@gmail.com
Chief of Controls	Gavin Gallino	503-887-4624	ggallino@gmail.com
Press Officer	Mike Shaw	503-969-2867	mike@oregonwings.com
Chief Scrutineer	Blake Lind	503-803-9859	tech@oregonrally.com
Registrar	Ashlee Kardos	509-539-7182	registration@oregonrally.com
Communications	Brien Morris	971-202-9194	brienmorris@yahoo.com
Safety/Spectator Areas	Mike Day		daym@pacifier.com
Sweep Captain	Topher Riches	360-901-6562	christopher.riches@yahoo.com
Volunteers	Mackenzie Bartlett	503-442-3342	volunteers@oregonrally.com
Service Area Chief	Kory Nelson	503-803-8747	giterdun@comcast.net
Spectator Guide	Jeff Zurschmeide		
Media/Promotion	Mike Shaw, Jordan Trevor, Doug Heredos		
0, 00, 000 Cars	Team Fugawi?		
Trophies	Rebecca Ruston		
Stage Captains:	Jake Castedo, Mike Nagle, Chris Portal, La'Akea Siverts		
ARA Stewards:	Mark Everett	914-414-1110	mark@goeverett.ca

The Oregon Trail Rally is Held under the General Competition Rules of ARA. All applicable American Rally Association rules and bulletins are available at [americanrallyassociation.org](http://americanrallyassociation.org).

## Official Notice Board

On Friday, May 31, the notice board will be at registration at Portland International Raceway, then move into the motorhome at the base of the infield tower near registration for the duration of Friday competition. The board will be on display at the rally start at Eagle's Aerie in The Dalles, Oregon, on Saturday, June 1, and then at the service area at the Goldendale High School. Saturday night, the notice board will move to the mid-rally party at Pete's Pizza. On Sunday, June 2, the board will be moved to the rally start at Main Street in Dufur, OR, then to the service area in the Dufur City Park. It will be brought to the podium location at the conclusion of competition.

## Section 5: Description

The Oregon Trail National Rally and Rich Olmstead Regional Rally will take place from Friday, May 31 through Sunday, June 2. There will be approximately 120-140 stage miles. The total event distance will be approximately 400 miles.

A bulletin will be released with a detailed stage schedule and mileage. Stage maps and GPS coordinates will be provided to registered teams by May 16, 2019.

Spectators will be charged an admission fee at Portland International Raceway on Friday. The fee will be \$15 for adults, \$6 for children ages 6-12 with children under 6 free with paying adult. All competitors and service crews will be admitted free if they have signed the waiver and are wearing an approved wristband.

**On Friday, May 31 after 3:00 PM, anyone entering PIR without a wristband must pay to enter.** There will be rally personnel available to issue wristbands to legitimate competitors and crew at recce registration on Wednesday, May 29 before 3:00 PM on Friday, May 31 at registration at Portland International Raceway. If you have service crew that will be arriving after 3:00 PM, contact Doug at [doug.heredos@gmail.com](mailto:doug.heredos@gmail.com) before Friday, May 31, to make arrangements for entry to PIR.

## Section 6: Entry and Entry Fees

Entries and entry fees shall be submitted online at  
<https://usacracing.redpodium.com/2019-ara-race-registration>.

Competitors needing a competition license should visit:  
<https://usacracing.redpodium.com/2019-ara-rally-license>

### Entry Fee Schedule:

Early Entry: April 2 to May 1

Regular Entry: May 2 to May 15

Late Entry: May 16 to May 31

Event	Early Entry	Regular Entry	Late Entry
Oregon Trail National	\$1,025	\$1,225	\$1,425
Rich Olmstead Regional	\$825	\$925	\$1,025
<b>Discounted Entries:</b>			
Rich Olmstead Regional (First Rally Ever for Driver)	\$300	\$300	\$300
Rich Olmstead Regional (Long Haul)	\$625	N/A	N/A
Driver's Name is John Buffum	\$0	\$0	\$0
Rally Car is a Homologated Group B Car	\$0	\$0	\$0
<b>Notes:</b>			
(1) All dollar amounts in US Dollars			
(2) Early regional entries from outside of Oregon or Washington will receive a \$200 "long haul" discount. Place of origin will be determined by the driver's state-issued identification. This discount is available only for regional entries. The discount will be automatically applied when you enter online.			
(3) "First Rally Ever" discount is for drivers who have never competed in a rally, ever. Please be honest. We will research it! Cannot combine with long haul discount. Email <a href="mailto:doug.heredos@gmail.com">doug.heredos@gmail.com</a> for a special code to use.			
(4) Entrants can combine the regional Subaru early entry and first rally ever discounts. If this is your first rally ever and you are one of the first 10 regional entrants in a Subaru, your entry fee is \$0! Enter using the regional early entry code below and we will issue a refund – email <a href="mailto:doug.heredos@gmail.com">doug.heredos@gmail.com</a> to inform if this will be your first-ever rally.			
(5) If someone legally changes their name to John Buffum and enters the rally in a homologated Group B car, we will honor the \$0 entry fee. We know you were wondering this. Email <a href="mailto:doug.heredos@gmail.com">doug.heredos@gmail.com</a> for a special code to use.			

The "Subaru Early Entry Fee" is available to the first ten paid Subaru teams in the National and the first ten paid Subaru entries in the concurrent Regional rally ([vtcar.com/rally/subaru-contingency-program/](http://vtcar.com/rally/subaru-contingency-program/)). This reduced "Subaru Early Entry Fee" will be \$500 below the normal Early Entry Fee for a National entry, and \$300 below the normal Early Entry Fee for a Regional entry. Teams receive the National credit when they pay their entry fee by using the coupon code "OTRSUBNAT", and the regional credit using the code "OTRSUBREG"

Oregon Rally Group reserves the right to refuse any entry. Notification of such refusal will be sent to the entrant at the email address given on the entry form as soon as possible.

Entry includes event entry and American Rally Association event insurance, one single set of Jemba produced course notes, one set of service crew instructions, and one service space at all service areas equivalent to 24 feet by 40 feet. You may purchase an additional clean set of notes for \$25.00 or an oversize service space for \$250.00.

An oversize service space and additional set of stage notes must be purchased and paid for no later than May 16<sup>th</sup>, 2019.

**Refunds:** An entry fee will be refunded if an entry is not accepted, the vehicle does not pass scrutineering, or if the event does not take place. Once the vehicle has passed scrutineering, the entry fee is not refundable. Entry fees will be refunded minus a \$100 processing fee if entry is withdrawn prior to May 16<sup>th</sup>, 2019.

**Teams will not be able to complete registration until the entry fee and any other applicable fees are paid in full.**

**Contingency Programs:** Check [americanrallyassociation.org](http://americanrallyassociation.org) for the most up-to-date contingency program information.

Subaru Contingency Program information and registration is at [vtcar.com/rally/subaru-contingency-program](http://vtcar.com/rally/subaru-contingency-program).

## **Section 7: Scrutineering**

Cars must pass tech inspection prior to registration.

The car will be clean (washed) inside and out when it reports for scrutineering. Vehicles presented for tech inspection that are dirty will be refused scrutineering until they are cleaned.

## **Section 8: Event Sponsor Advertising**

For the 2019 Oregon Trail Rally, we hope to be issuing sponsor decals to be placed in the event space, which is located under the number on each door of the competition vehicle.

All competing vehicles will be required to place event sponsor decals on their car, in the space allocated to event sponsor advertising as described in the 2019 American Rally Association Rules. Any competitor not wishing to carry this sponsorship advertising will be required to pay an Event Sponsorship Waiver Fee of \$750 for national entrants, or \$300 for regional entrants.



## Section 9: Service

On Friday, May 31, the service area will be at the Portland International Raceway at 1940 N Victory Blvd, Portland, OR 97217. On Saturday, June 1, the service area will be at the Goldendale High School at 525 E Simcoe Dr, Goldendale, WA 98620. On Sunday, June 2, the service area will be at the Dufur City Park in Dufur, OR.

The move-in times for service are as follows:

Friday, May 31: North Paddock, PIR, move-in 9:30 AM  
Saturday, June 1: Goldendale High School, move-in 8:00 AM  
Sunday, June 2: Dufur City Park, move-in 8:00 AM

All service must be performed in designated Service areas. Service spaces will be assigned by the service area coordinators prior to the start of competition for Portland International Raceway, Goldendale High School, and Dufur City Park.

**Requests for multiple cars servicing together, or special service requests, must be sent to the Service Area Coordinator, Kory Nelson at [giterdun@comcast.net](mailto:giterdun@comcast.net) no later than Friday, May 16<sup>th</sup>, 2019.**

Any teams needing to use a service space larger than 24 feet by 40 feet in any Service Area must purchase an oversize service space for \$250, payable with your entry fee. After May 16<sup>th</sup>, oversized spaces may not be available. Teams that purchase an oversize service space should provide a diagram of their preferred service space layout to the Service Area Coordinator, Kory Nelson at [giterdun@comcast.net](mailto:giterdun@comcast.net) no later than May 16<sup>th</sup>, 2019.

**Trailers will not be allowed in service areas** unless they are functionally necessary for normal service operations. Trailers must be parked in the designated trailer parking spot on Friday, Saturday and Sunday (instructions to which will be in the service crew instructions).

Vehicles that are not officially registered with a team as a service vehicle will be not allowed in the service area. Parking will be available outside the service area.

**Service crews must notify the Service Area Coordinator or Service Area HAM when they leave the service area to retrieve a broken car.**

Service crews will be required to display the organizer-supplied car number placards in a prominent location that is visible from the road through the service area. This makes it so that a rally official can locate a service crew quickly if needed.

Tarps/spill cloths must be placed under cars for all servicing operations. Minimum penalty is one six pack of good beer payable to event Chair. Max penalty \$50.

Competitors are not required to drive through fuel depots if they don't require fuel. Purchasing fuel from commercial gas stations located along transit sections of the route is permitted. All work involved in adding such fluids on transits must be performed by the

driver and co-driver or, in the case of fuel from commercial gas stations, by the station attendant only per Oregon state law. No added allowance is included in transit times for such fueling.

Please note that there is a gas station in Dufur. We all like to support our local communities, so why not fill up in Dufur?

On Friday May 31, cars are expected to be fueled prior to checking in to the initial parc exposé. It is a very short evening, and there will be no time allotted for refueling. A refueling area will be set up for emergency refueling only.

On Friday, May 31, no time controls exist at service stops. After stages 1 and 2, service breaks will occur. Service time will be included in the transit time from the stop control of the previous stage to the ATC of the next stage. This is designed primarily to allow the field to complete the super special stage before the first car starts the next round of super special stage. Please take this time to showcase your car/team to the fans.

**Please note: the speed limit on the grounds of Portland International Raceway is 15mph. Spectators are mingling throughout the area. Be respectful of their presence!**

**The service park at Portland International Raceway will close at 10:30 PM. All teams must be packed and out of PIR at this time. The front gate closes and locks at 11:00 PM, with no further passage available.**

## **Section 10: Course Notes/Pace Notes**

Jemba notes will be provided. Absolutely no pre-running of the stages is permitted except during reconnaissance (See section 12). Teams may not participate in reconnaissance without first purchasing the course notes from Oregon Rally Group. In this case, as course notes are included in the entry fee, payment of the entry fee will constitute purchase of the course notes.

## **Section 11: Optional Recce**

Open Optional Recce will be offered for the 2019 Oregon Trail Rally on Thursday, May 30 from 7:30 AM to 6:00 PM. Recce is prohibited outside of this designated time per American Rally Association Rally Competition Rule 1.2.1(a). Competition vehicles may not be used for recce.

You must register for recce to collect routebook and Jemba Notes. There will be two opportunities to register for recce;

Wednesday, May 29 4:00 PM to 8:00 PM, at Location TBA – This is the primary opportunity. Bring your service crew so they can sign the waiver and get into PIR on Friday.

Thursday, May 30 7:00 AM to 8:00 AM at the host hotel, the  
Fairfield Inn, 2014 W 7th St, The Dalles, OR 97058.

A suggested order of stages for recce will be supplied to competitors to ensure that they can complete at least one pass over all stages in Klickitat and Wasco Counties. **Speed limit on stages during recce will be 35 MPH unless the posted speed limit is lower.**

The optional recce will be run on open, public roads and oncoming traffic should be expected at all times. All traffic laws for the states of Oregon and Washington must be observed. All speed limits and **quiet zones listed in the Route Book MUST be observed.** All competitors shall have the car number of the entrant placed on the rear window in no less than 2" and no more than 4" white vinyl numbers (provided at recce registration). All participants must stop at any Observation Controls (O Control) they encounter. Volunteers working to set up rally stages for the weekend, and observers on behalf of the organizers in the area, are to be judges of fact in all matters.

Inappropriate behavior shall be penalized as laid out in the American Rally Association Rally Competition Rule 1.2.1 (g), and is defined as any of the following but not limited to: reckless driving; speeding (on stage or in a quiet area as observed by the judges of fact; or as patrolled by local authorities); failing to stop at an Observation Control; disobeying orders from an event official; being on the stages outside of the prescribed recce hours; not having recce numbers on the car.

## Section 12: Press Stage and Charity Shakedown

The shakedown is open to any competitor whose car passes scrutineering. The shakedown stage is approximately 1.5 miles in length and uses a portion of the Friday night competition stage.

Each car is entitled to one free shakedown pass.

Each subsequent shakedown pass will cost \$20, with all proceeds going to Northwest Animal Companions (NWAC), an animal rescue in Portland.

Teams are encouraged to bring guests and sponsors for charity rides.

The rally will pay \$20 to NWAC for each shakedown pass for members of the press and guests of the rally.

The rally will have a small selection of helmets and H&N restraints for guests. Teams are encouraged to bring extra helmets and H&N restraints if available. Driver must wear full racing suit, helmet and SFI 38.1 or FIA approved head-and-neck restraint device.

Media personnel wishing to participate in the Press Stage must contact the Press Officer, Mike Shaw at [mike@oregonwings.com](mailto:mike@oregonwings.com). Media personnel must also apply for credentials with ARA per the Media Policy and Accreditation document found on the ARA website at <https://www.americanrallyassociation.org/media>.

Shakedown begins at 10:30 and ends at 1:00pm. Every effort will be made to ensure every team who wants a shakedown run gets one, but this is not guaranteed. Runs will be first come, first served.

### Section 13: Traffic Infringements and Other Oregon Laws

The American Rally Association Stewards will review any traffic citation received during the running of the event by any crew or service crew.

It is forbidden to drive on public roads with auxiliary lights turned on.

Oregon State law prohibits self-serve pumping of gasoline at service stations. You must wait for a service station attendant to pump the fuel. (At least there's no sales tax.)

Oregon State law requires that your headlights be turned on if the windshield wipers are in use. **The organizing committee strongly requests that all competition and service vehicles turn on the headlights while on open, public roads.**

### Section 14: Marshals' Identification

Control marshals will wear orange vests.

### Section 15: Reseeds

There will be two complete reseeds during the rally. One will be mid-day Saturday, and one will be Sunday morning.

### Section 16: Chicanes and barricades

Chicanes will be used on some stages per American Rally Association Rules. Chicanes will be three-element chicanes with a right entry. The main element of each chicane will be a 41" traffic drum like the one pictured. The first element of each chicane will consist of 28" cones standing. The remaining elements will consist of cones laid on their sides. The distance between chicane elements will be approximately 30 yards.

A complete three-element chicane will look like this:



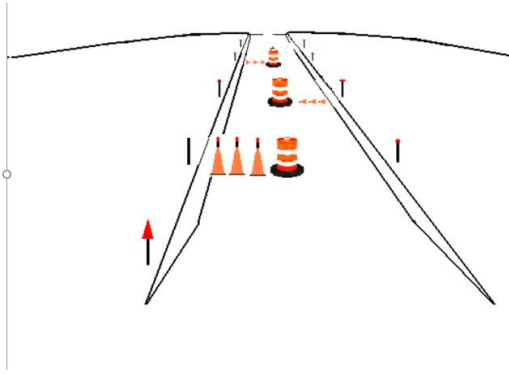

Chicane crews will monitor chicanes and attempt to reset chicane elements that are hit by cars. Chicane crews are judges of fact.

Drivers are expected to slow significantly and make an earnest attempt to negotiate each chicane without hitting any elements. Blatant failure to negotiate a chicane will result in a 30 second penalty. Blatant failure is defined as: 1. Displacing two or more main elements by more than 15", or knocking over two or more main elements, or 2. Passing any main element on the incorrect side.

### **Section 17: Amendments to the Regulations - Supplements**

Amendments or additional provisions to these regulations will be announced by dated and numbered information bulletins. The bulletins will be regarded as an integral part of these regulations. The bulletins will be posted on the official notice board, and may also be directly communicated to the participants during the running of the event. Participants must acknowledge receipt by signature of bulletins directly communicated at time control points, unless this procedure is materially impossible.

### **Section 18: Exceptions from American Rally Association Rules**

**The following exceptions will be in effect for Friday, May 31 only:**

The start interval shall be 30 seconds.

<Note that cars will *not* start in reverse order, as has been the case for several years>

### **Section 19: Transiting After a Stage Stoppage**

If a stage is blocked, stopped, or cancelled please follow the directions of the marshals. The Clerk of the Course will address any issues with transit times at the next opportunity. Do not exceed posted speed limits.

## Section 20: Weather contingency

Oregon Trail Rally organizers will inform competitors, crews, and volunteers of the weather contingency in the case of roads becoming impassable due to inclement weather conditions. This communication will take place as soon as is feasible once it becomes clear the rally cannot go forward under the conditions and in the usual fashion via driver's bulletins and driver's meetings.

## Section 21: Mileage Markers

Mileage markers will be placed at half-mile intervals along the stage routes.

Cautions will be designated by signs bearing the appropriate number of exclamation points, before the point of the caution.

## Section 22: Damage to PIR Facility and Service Area Cleanup

Drivers will be held financially responsible for damage to PIR facilities (i.e., guard rail, gates, fences, etc.) due to off-course excursions or other incidents. As Oregon Rally Group is charged for cleanup of the paddock area, drivers and crews are to leave PIR clean. Garbage is to be placed in proper receptacles, and it is imperative that participants leave their service spaces without clutter (i.e., tires, loose garbage, etc.). Tires are to be removed from PIR by competitors as there is no provision for their disposal at PIR. No oil barrels are provided at PIR. Hazardous wastes, including oil, solvents, brake clean, brake fluid, antifreeze, etc., **MUST** be taken with you when you leave PIR.

Teams are expected to leave ALL service areas clean of fluids, tires, fuel drums, and garbage.

## Section 23: Provisional Scores

Informational scores may be posted throughout the event at various locations. Provisional scores will be posted at The Threshing Bee in Dufur, OR at approximately 7:00pm, or earlier if possible. Scores will be final 30 minutes after posting or after all claims are resolved. The Threshing Bee is located near Heimrich Street and Airport Way in Dufur, not far from Service.

## Section 24: Awards

The Oregon Trail National Rally awards will be determined and presented by Oregon Trail Rally and the American Rally Association. The American Rally Association National classes are Limited 4WD, Naturally Aspirated 4WD, Open 2WD and Limited 2WD. Awards are also given according to the National Overall classification.

Event awards will also be given for the Rich Olmstead Regional Rally in Open 4WD, Limited 4WD, Naturally Aspirated 4WD, Open 2WD and Limited 2WD classes. Awards are also given according to the Regional Overall classification.

### **Section 25: Prize Giving**

The prize giving will take place at the end of the event on Sunday, June 2 at the Threshing Bee field in Dufur, Oregon. The Threshing Bee is located near Heimrich Street and Airport Way in Dufur, not far from Service.

**Section 26: Maps**

**1. Overview Maps**

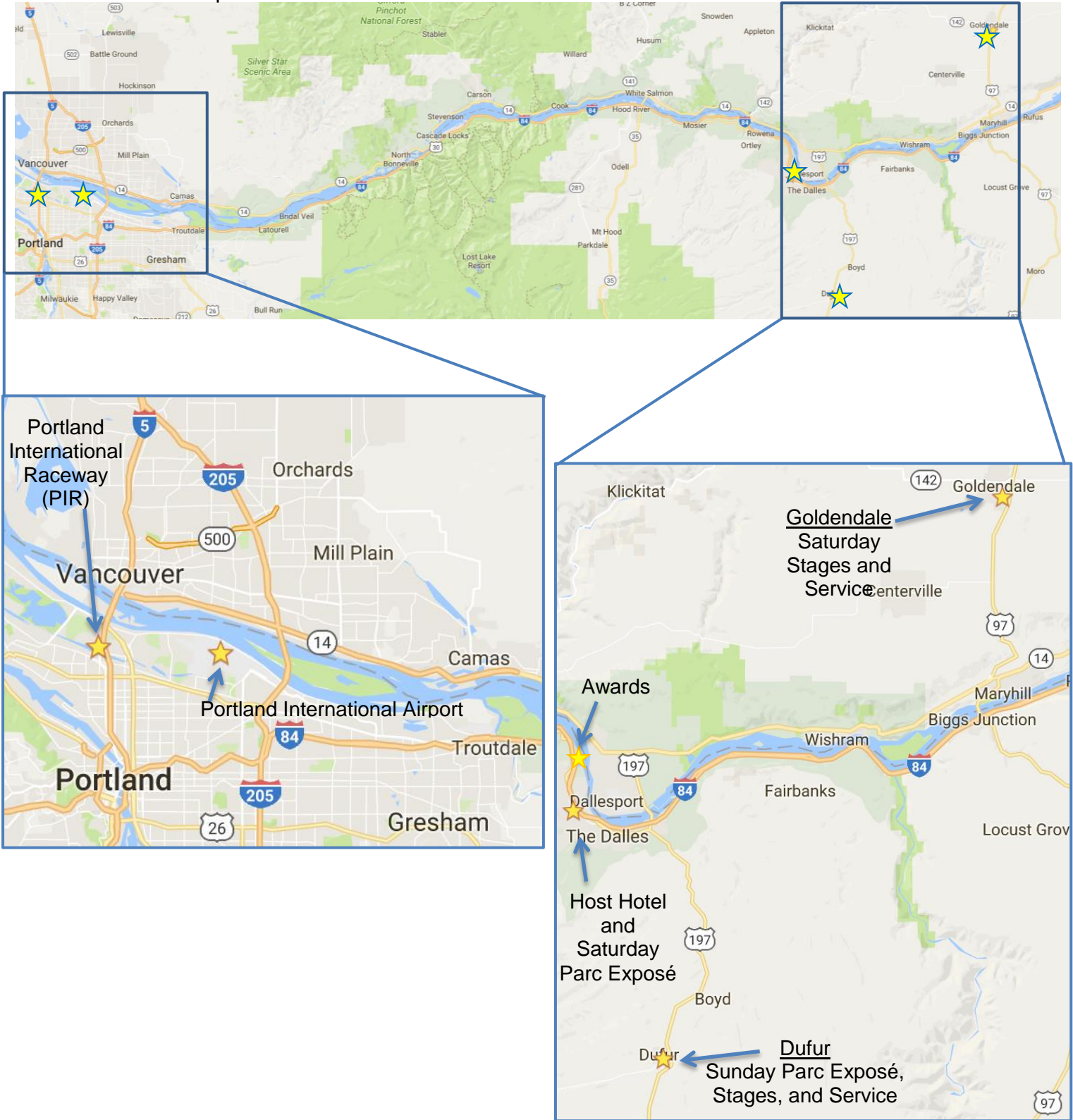



## 2. Portland Area

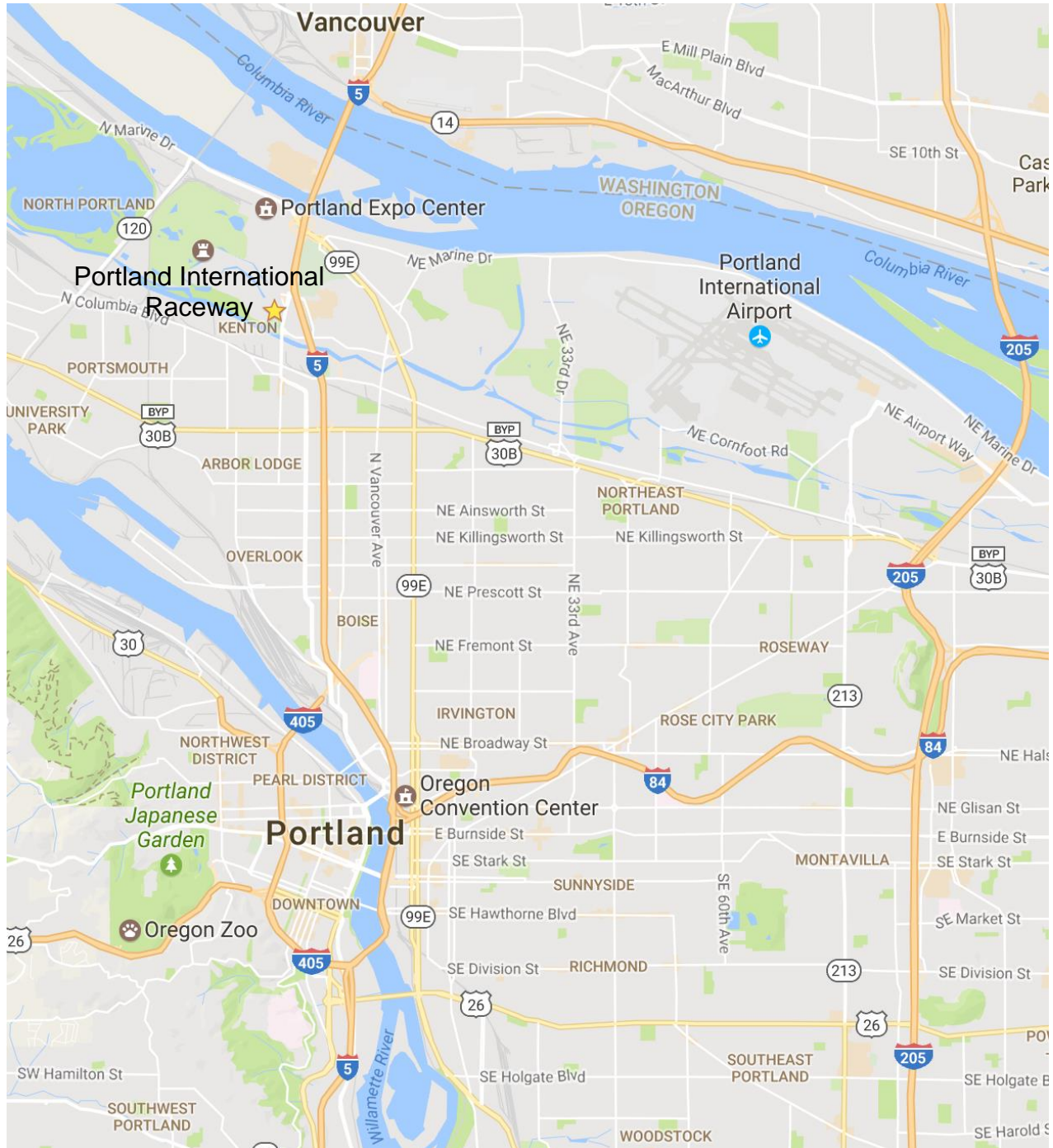

Competitor route to move in to service area at Portland International Raceway, 1940 N Victory Blvd, Portland, OR 97217

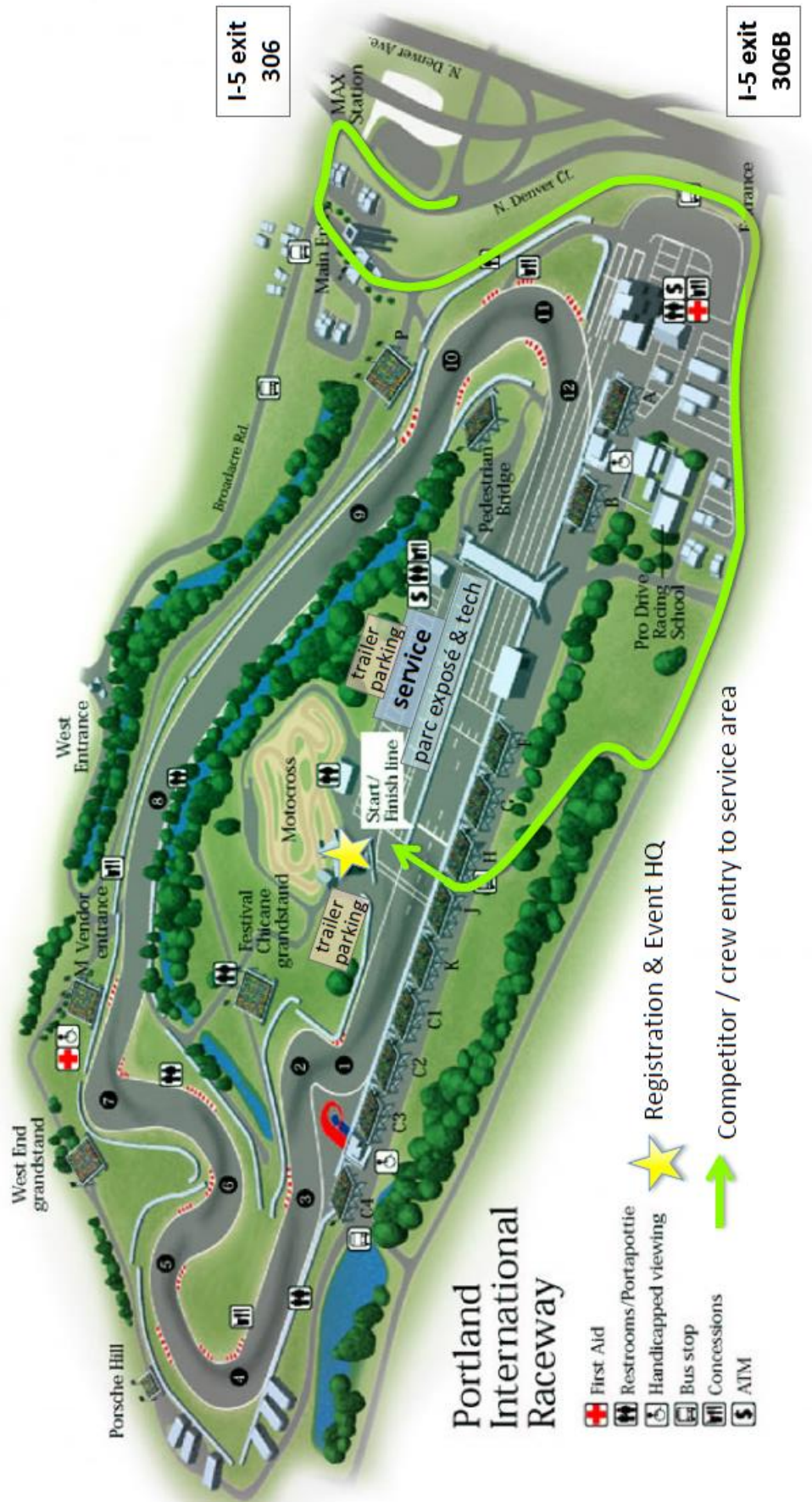

4. Saturday and Sunday Overview Map



5. The Dalles, Oregon

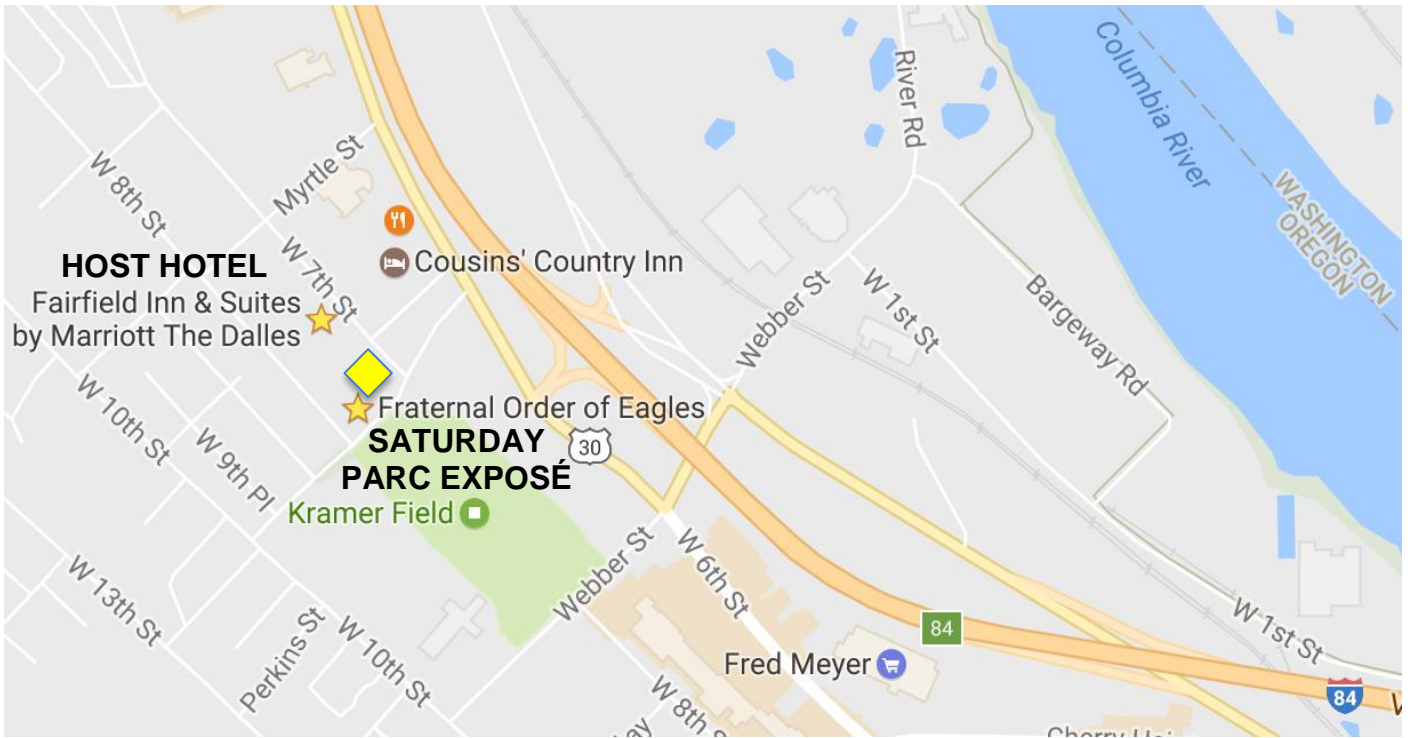

6. Goldendale, Washington



7. Dufur, Oregon

